

State of South Carolina

(192)

Pursuant to a warrant from John Thomas Esq. Commissioner of Locations I have admeasured and laid out unto Jonathan Whiten a tract of Two hundred and fifty acres of Land situate in Ninety Six district, on the waters of Enoree River, bounding N.E. on land laid out to Hendrake, all other sides on vacant land and land laid out, and hath such Shape and Marks as the annexed Plat Represents.

Surveyed the 10th day Sept. 1784

Recorded the 3. Nov. 1784, David Hopkins Esq.

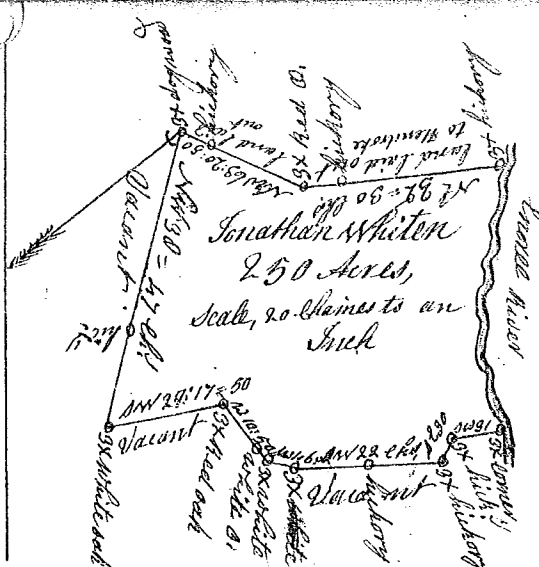

State of South Carolina, Ninety Six District

Pursuant to a warrant to me directed by John Thomas Esq. Commissioner of Locations for said district No. side of Saluda River, I have surveyed and laid out unto William Wood a tract of land containing 150 acres situate lying and being below the ancient boundary line, on both sides of fair forest of Tigar River bounded S.E. on Thomas Williamson's land, on all other sides by Richard Prince's land, and has such Shape and Marks as the annexed plat Represents.

Surveyed the 1st day of Oct. 1784 James Seaborn Esq.
Recorded the 3. Nov. 1784,

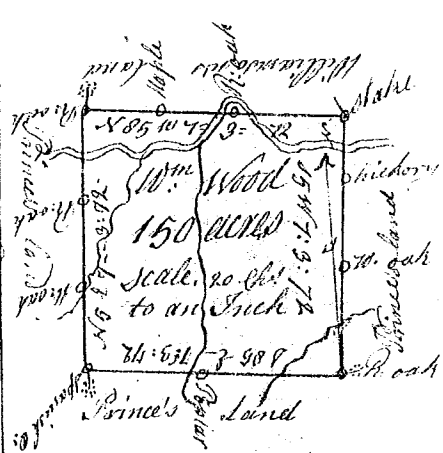

State of South Carolina

Pursuant to a warrant from John Thomas Esq. Commissioner of Locations, I have admeasured and laid out unto Robert Smith a tract of ninety one acres of land, situate in Ninety Six District on Browns Creek - Bounding NW on land laid out to Joshua Palmer, all other sides on ~~vacant~~ lands laid out, and hath such Shape and Marks as the annexed Plat Represents.

Surveyed the 2^d day Sept. 1784 David Hopkins Esq.
Recorded the 3. Nov. 1784,

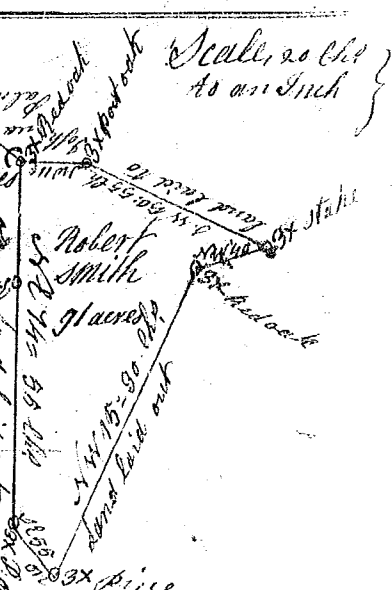

State of South Carolina

Pursuant to a warrant from hand and seal of John Thomas Esq. Commissioner of Locations in the Ninety Six District, No. Saluda River bearing date the 17th July 1784 I have admeasured and laid out unto Thomas Holland a tract of land containing two hundred acres on a small branch of Duncans creek below the Indian boundary, bounded S.E. on land laid out to John Glen Esq. on a bounty survey and land laid out for Patrick Bryan NW on Duncans land, NE on land laid for Edward Myler, and hath such Shape and Marks as the annexed Plat Represents.

Surveyed the 2th day July 1784 Robt. Hanna Esq.
Recorded the 3. Nov. 1784,

